

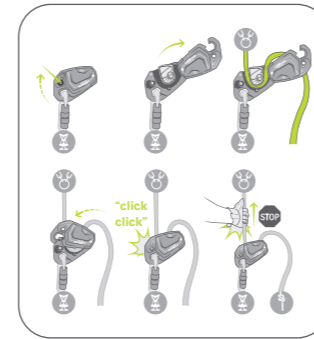

APPLICATION

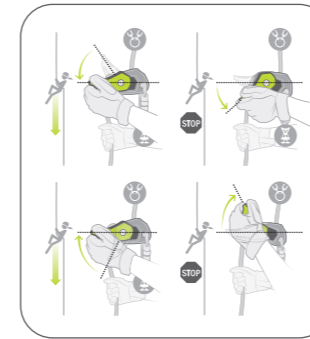

1. Installation



2. Function principle

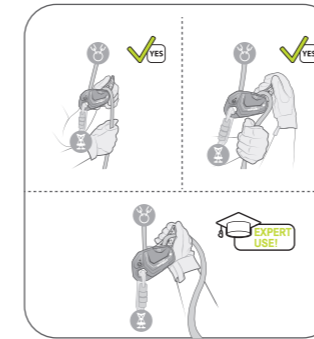

3. Handling

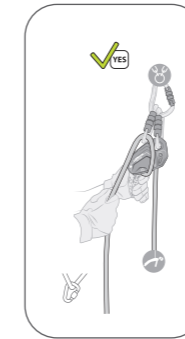

4. Descent from a fixed point

2912



EDELRID GmbH & Co. KG
Achener Weg 66
88316 Isny im Allgäu

Phone: +49 7562 981-0
mail@edelrid.de
www.edelrid.com



EDELRID *e*



- ✓ EN 12841-C
- ✓ EN 341-2A
- ✓ EN 15151-1/8
- ✓ ANSI/ASSE Z359.4

MEGAWATT

UNIVERSAL DESCENDER AND RESCUE DEVICE

- COMPACT AND LIGHT
- INTUITIVE HANDLING
- VERSATILE

FEATURES

Anti-panic function creates additional operating options

Steel inserts enhance the service life

Ergonomic lever with rubber-coated grip inserts for intuitive handling at minimum effort

Integrated RFID chip simplifies documentation of the application



Compact design with short lever prevents entanglement

Large karabiner hole allows 360° rotation of the karabiner

Safety lock allows inserting the rope with closed karabiner

MEGAWATT – THE MOST VERSATILE DESCENDER DEVICE IN THE MARKET

MEGAWATT is a universal descender device for industrial climbers and rescue operations with a payload of up to 200 kg. The intelligent transmission mechanics of the descent lever facilitate a large operating range and exact adjustment of the speed at minimum force.

The short lever always automatically returns to the parking position and makes the device extremely compact. This prevents entanglement. The ergonomic lever design with rubber coated grip inserts allows intuitive active and passive operation with the left or right hand.

The four-way safety lock allows inserting the rope without having to separate the device from the karabiner. Steel inserts in the especially burdened spots increase the service life of the device.

The risk of uncontrolled travel along the rope is reduced by the anti-panic function. It can also be triggered deliberately to reverse the sense of operation of the lever. This allows optimum handling in any application and position. All this makes the MEGAWATT the most versatile descender device in the market at a weight of only 495 g.

- Precision operation of the lever at minimum exertion
- Short lever and compact design prevent entanglement
- Automatic parking position of the control lever
- Ergonomic lever with rubber-coated grip inserts for intuitive handling with the left or right hand in active and passive applications
- Four-way safety lock allows inserting the rope without having to separate the device from the karabiner
- Large karabiner hole allows 360° rotation of the karabiner
- Anti-panic function reduces the risk of uncontrolled descent movements and creates additional operating options
- Steel inserts in the especially burdened spots increase the service life
- Interlocking bolt supplied with the lever allows use as a closed system
- Descent of heavy loads of up to 200 kg
- For a rope diameter of 8.9 to 11.8 mm
- Meets the standards EN 12841-C, EN 341-2A, EN 15151-1/8 and ANSI/ASSE Z359.4
- Integrated RFID chip simplifies documentation of the application

N°.	WEIGHT	COLOR	CERTIFICATION
88332	495 g	017 night	EN 12841-C EN 341-2A EN 15151-1/8 ANSI/ASSE Z359.4

	Application*	Rope	Max. descent speed	Max. descent distance	User weight	Deflection of braking rope	Energy during descent**
EN 12841-C	normal	10,0 -11,8 mm EN 1891	2 m/s		≤ 120 kg	not required	
	rescue	10,0 -11,5 mm EN 1891	1 m/s		max. 200 kg	required	
EN 341-2A		With EDELRID PERFORMANCE STATIC 11.0 mm + Weblink only	2 m/s	200 m	30 -120 kg	required	7.500.000 J
ANSI/ASSE Z359.4		10,0 -11,5 mm EN 1891 + Weblink	2 m/s	200 m	49 -120 kg	not required	300.000 ft lbs (multiple descent)
					121-141 kg	required	
EN 15151-1/8		8,9 -11,0 mm EN 1891 EN 892				not required	

*Please observe the instructions for use!

** = × × ×
 (W[J]) (g=9,81 m/s²) (m[kg]) (h[m]) (t)

** = × ×
 (E[ft. lbs]) (W[lbs]) (H[ft]) (t)